



Corn Alley and American Road
P.O. Box 232
St John's, Antigua, W.I.

Tel/fax; (268) 462 1261
Tel/Fax (268) 560 2665

www.s-o-ltd.com

The company reserves the right to change the product design and the specification without prior notice



S.O. Ltd **Salsa Storm Evaporative Air Cooler**

Model: SO900-A
Operating Instructions



COOL STORM

Please read this Instructions carefully before using this product

Technical Specification

Model	Voltage	Power	Noise Level	Water Tank Capacity	Humidifying Capacity	Efficiency	Air Flow Rate	N.W	G.W	Dimension(mm) L×W×H
SO900-A	120V~60Hz	180W	65dB(A)	20L	4.8L/h	16	1000m ³ /h	15kg	17.8kg	442X608X1012

Note: 1. The water consumption will vary depending on the relevant humidity.
2. The above data s for reference only.

TROUBLE SHOOTING

Symptom	Cause	Remedy
No air flow	1. Power is not connected. 2. Power is not turned ON. 3. Body damaged.	1. Plug in the power cable properly. 2. Press the Air Speed button to start. 3. Return to Service Center.
Continuous blowing	Unit damaged	Return to Service Center
Unusual noises	1. Foreign material inside the unit. 2. Loose fan. 3. Motor defect.	1. Remove rear cover and screen, remove foreign articles. 2. Return to Service Center. 3. Return to Service Center.
Not cooling	1. Air filter screen blocked. 2. Water pump inlet blocked 3. Other cause.	1. Clean filter screen. 2. Clean the water pump. 3. Return to Service Center
Swing feature does not work	Defective swing drive motor	Return to Service Center

Negative Ions and Health (reference only)

Location	Capacity (s/cc)	Health benefits
Forest , Cataract	100000~500000 ion	Naturally Healthy
Mountain Seaside	50000~100000 ion	Healthy, reduces allergies and transmission of disease
Suburb Field	5000~50000 ion	Enhance immunity
City Park	1000~2000 ion	Maintains basic health
Urban Areas	100~200 ion	Reduced physiological edge
Residence	40~50 ion	Increased headaches, losing sleep, tired,
		Increased allergies, respiratory disease infestations
Air Conditioning House	Long term exposure 0~25 ion	physiological diseases

Ion--Negative Ion s--Quantity of Ions cc--Milliliter

Thank you for choosing the SO900-A, Salsa Storm portable evaporative air cooler. Please read this instruction manual carefully before operating the unit.

External part identification

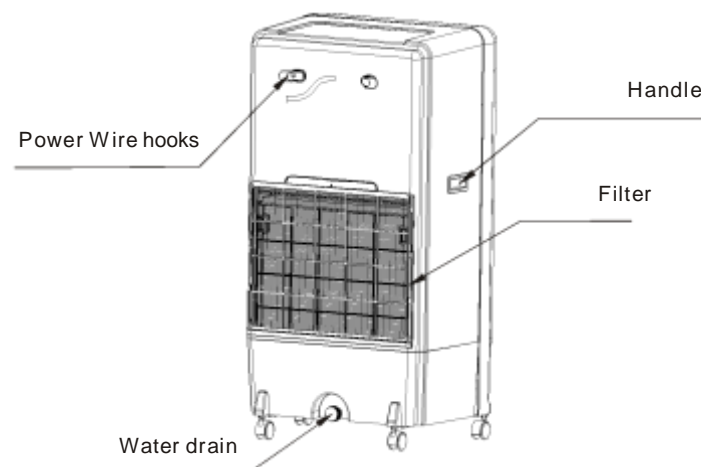
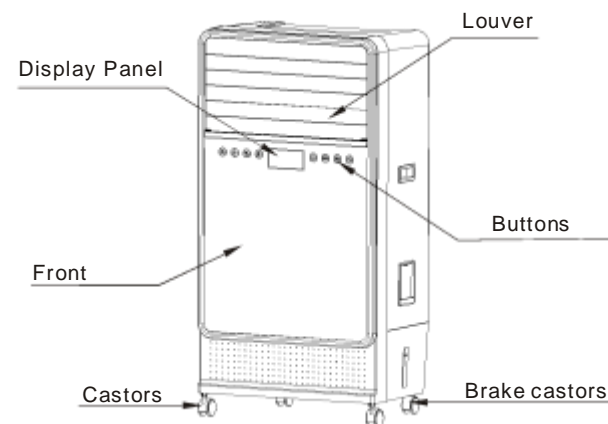

DISPLAY PANEL

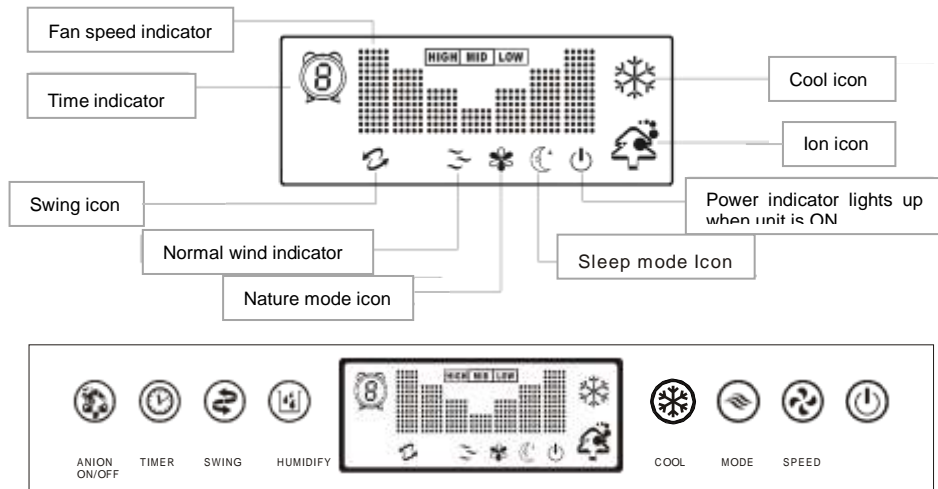

- ANION
- TIMER
- SWING
- HUMIDIFY
- COOL
- MODE
- SPEED
- ON/OFF

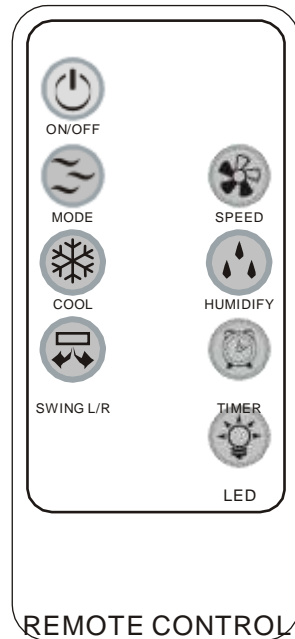

6. To avoid unpleasant odors, please drain unit and run in fan mode to dry out unit before putting it in storage or transporting it.
7. Unplug unit when it is not in use.
8. If the power cord is damaged, it must be replaced by the manufacture, its service agent or a similarly qualified person in order to avoid a hazard.
9. This unit has a powerful humidifying effect, and must always be operated in a well ventilated area. Do not use in a closed area.
10. Drain water tank of old water and clean the tank at least once a week.
11. This appliance is not intended for use by persons (including children) with reduced physical, sensory or mental capabilities or lack of experience and knowledge, unless they have been given supervision or instruction concerning use of the appliance by a person responsible for their safety.
12. Always top up water tank with clean water and do not overfill to avoid spill hazard.

How to change battery for the remote

1. Pull the battery outward.
2. Put in the new battery with the "+" on the top.
3. Put the battery box in the controller.

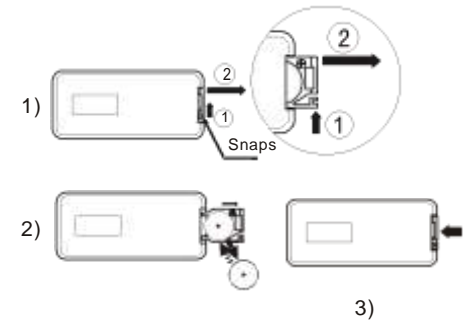

Electrical schematic diagram

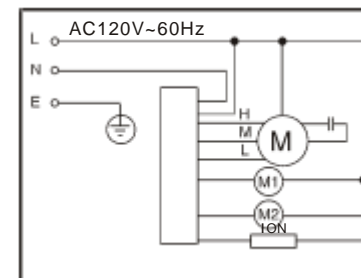

CAUTION

1. Use AC120V/60hz power supply
2. After filling with water, do not tilt or drop the unit. Please move the unit carefully to avoid splash hazard.

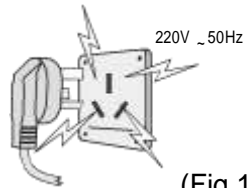

(Fig.1)



(Fig.2)

3. Do not place objects on the top of the unit. Do not cover the air outlet when in use. Do not restrict airflow into the rear of the machine. Always leave a minimum space of 300mm at the rear to maintain good airflow



(Fig.3)



(Fig.4)

4. Do not place or operate the unit in an area with extremely high or low temperatures.
In summer/hot periods, the water must be changed frequently to avoid odors and maintain effective cooling.
In winter, with temperatures 5 degrees C or lower drain and dry out the water tank to avoid frost damage.
5. Always use a mild detergent and a damp cloth when cleaning the unit. Do not use any corrosive cleaner or solvents. Do not rinse the unit with water.



FUNCTIONS OF ALL BUTTONS

ON/OFF Press to turn the unit ON or OFF



MODE



The Normal mode is preset when the unit is switched ON. Press to turn unit from NORMAL to NATURE mode. Press again to go to the SLEEP mode and repeat to return to NORMAL mode.

COOLING



This function is preset and comes on automatically when the unit is switched ON. Press again to switch OFF cooling mode. (Note: When the cooling function operates, the fan automatically runs on low speed for 30 seconds.)

SWING L/R



This function is preset and comes on when the unit is switched ON. The swing indicator will remain lit while the swing function is in operation. Press to stop this function, and press again to start swing function.

SPEED



Press to select the desired fan speed. LOW, MEDIUM or HIGH

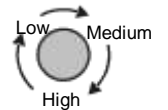

HUMIDIFY



Press to start the humidifying feature. Cooling function will stay off. (Note: When the humidifying feature operates, the blower will be limited to low speed.)

TIMER



With the unit ON, press this button to set the desired run time up to 9 hours. Press again to exit the timer feature. (Note when the timer has timed out while in cooling mode, the unit will continue to operate for a short period in fan mode to dry the cooling pad.)

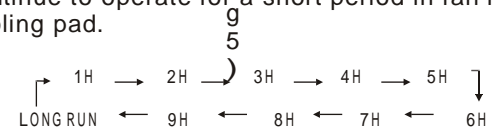

LIGHT



The display panel light comes on when the unit is turned on. This light will switch off automatically after 10 seconds. Press again to keep the display light on.

OPERATION GUIDELINE

1. Remove air cooler from the box. Check the contents. One Instruction Manual, one Remote control.
2. The unit should be placed on a level surface and must always stand in a vertical position. Check the power supply is correct. (Check data decal on the back of the unit)
3. Filling unit: When the machine is new or unused for a long period, fill with clean water before using. Unplug the unit before filling with water to avoid potential electrical hazard. Open the water filler hatch on the side of the unit. Fill tank with water. Note: Do not overfill. Fill to max level.
4. Adjustable louvers: Open louvers and adjust manually to desired position.
5. Timer: Press to set timeout timer from 1-9 hours. When the timer indicator light is off, the unit will operate continuously.
6. Remote control: Places all the controls at your fingertips.
7. Storage: Empty the water tank and dry out the unit before putting it in storage.

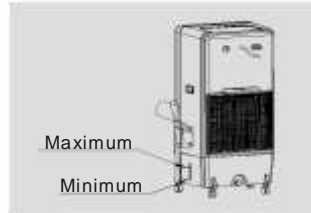

Pack it in plastic bag and put it in box.

8. Cleaning: The water tank, filter sponge, filter of water intake, water trough, cooling pad, and anti-static filter screen should be cleaned every, one to two weeks, to maintain efficient performance of the unit.

Note: Run the unit in low, cool for 5-10 minutes before changing the fan speed to get good cooling effect.

CLEANING METHOD:

- (1) Unplug unit.

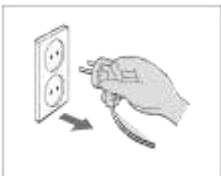

- (2) Drain the water

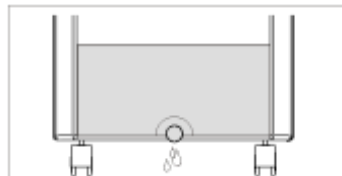

- (3) Pull out the anti-static filter screen, and take out the cooling pad.

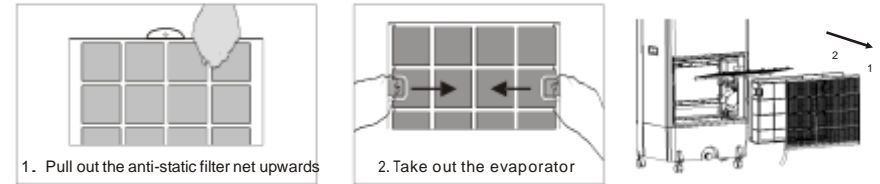

- (4) Take off the filter sponge and remove the filters from the intake water pipes.
- (5) Clean inside of the tank.

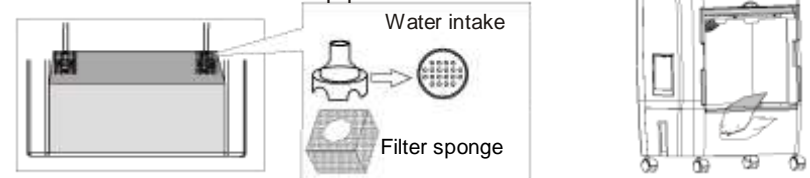

- (6) Clean the water tank, filter sponge, filter of water intake, cooling pad, and anti-static filter screen, and then refit.

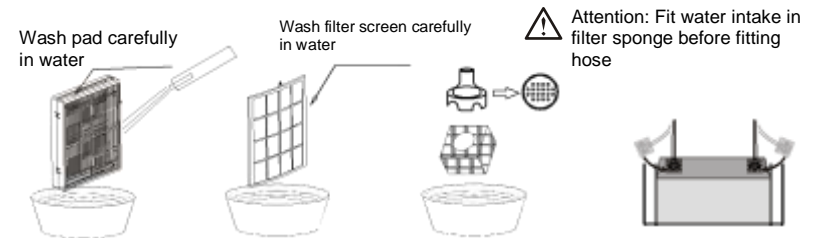

If the water is not circulating, check and clean the water pump intake filters and sponge. If no water circulates remove and clean the check valve on the bottom of pump.

(Attention: Clean check valve parts carefully to avoid damage)

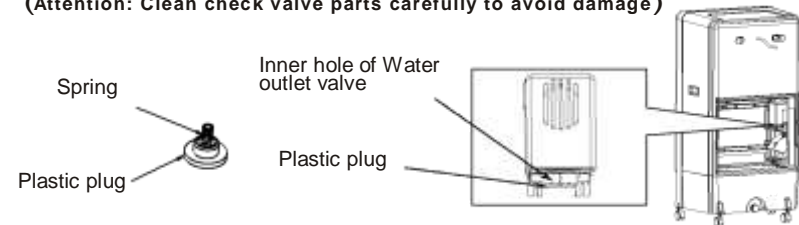

10. Always insure the evaporation pad is installed properly before using the unit. Incorrect fitment of the pad may shorten the operating life of the unit or may cause damage to the fan motor.

11. Always take care when moving the unit. Do not tip or tilt the unit to avoid splash hazard.